

## Removing and installing poly V-belt

Special tools and workshop equipment required

- ♦ Locking pin -T10060 A-

T10060 A

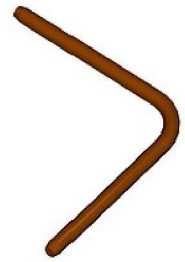

W00-11211

### Removing

- Release fasteners -arrows- and remove noise insulation.

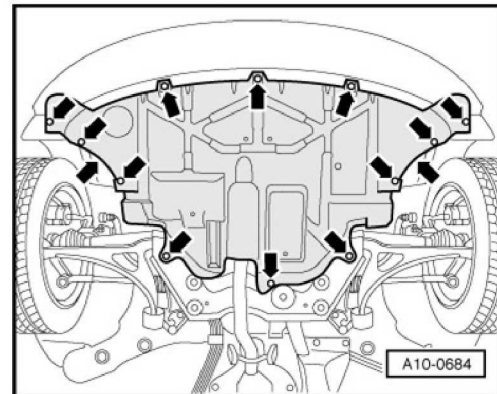

A10-0684

### Caution

*If a used belt runs in the opposite direction when it is refitted, this can cause breakage.*

*Before removing, mark direction of rotation of poly V-belt with chalk or felt-tip pen for re-installation.*

- To slacken poly V-belt use ring spanner to turn tensioner in clockwise direction -arrow-.
- Use locking pin -T10060 A- to lock poly V-belt tensioner and detach poly V-belt.

### Installing

Installation is carried out in the reverse order; note the following:

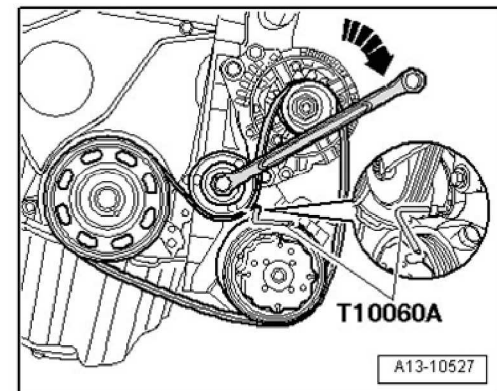

A13-10527

Routing of poly V-belt on vehicles with air conditioner:

- 1 - Poly V-belt pulley for crankshaft
- 2 - Tensioner
- 3 - Alternator
- 4 - Air conditioner compressor
- 5 - Poly V-belt

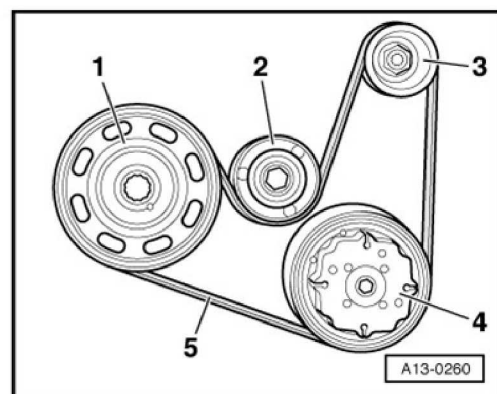

A13-0260

- Use ring spanner to turn tensioner slightly in clockwise direction -arrow- and pull out locking pin -T10060 A-.
- Check that poly V-belt is properly seated.
- Start engine and check that poly V-belt runs properly.
- Install noise insulation →Rep. gr.50.

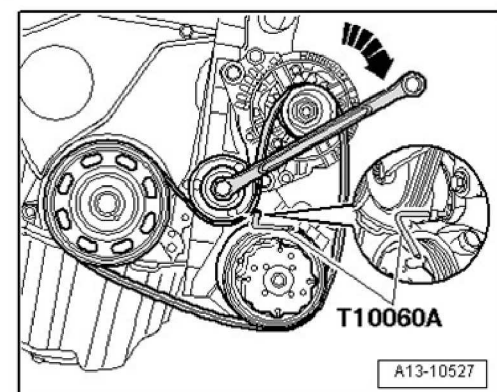

A13-10527